



Last updated on March 2026

User manual





Introduction

About this guide

This guide provides information about how to use the product functions to illuminate with this equipment as well as warnings on his use.

These are products of professional use for interior or studio and must be operated only by qualified technical personnel.

To obtain the maximum features, please read the following operating instructions very carefully before using this fixture for the first time. Please keep these operating instructions for you and subsequent users to reference in the future.

THELIGHT Luminary for cine and TV, S.L.

Safety precautions

For your own safety, please read and follow all safety instructions and warnings.

Exemption from liability

VELVET (THELIGHT Luminary) does not assume any responsibility for lighting failures caused by malfunction of this product. The manufacturer disclaims liability for any damage to persons or property caused by inappropriate operation, damage of this kind lies in the responsibility of the operator.

Warranty

This product is manufactured to local specifications and the warranty is valid within the country of purchase. Should the product fail or malfunction while you are abroad, the manufacturer assumes no responsibility for servicing the product locally or bearing the expenditure incurred thereof.

The total or partial reproduction of this guide is prohibited without the express written permission of VELVET.

VELVET technology is protected under Spanish license laws with international patents pending. Information and specifications in this document are subject to change without notice.

2025 © Copyright VELVET. All rights reserved.
www.velvetlight.tv

Working conditions

- Maximum allowed tilt angles are 90° up and 90° down.
- Ambient temperature (at the place of operation or storage):
Minimum -20°C Maximum + 45°C
- Minimum distances from inflammable surface:

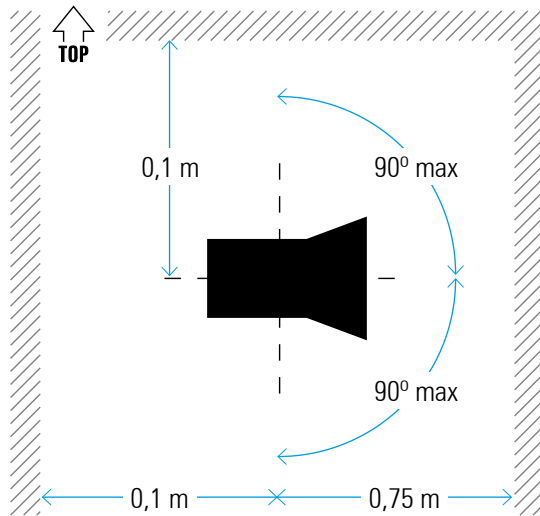

Safety precautions

Various symbols are used throughout this instruction manual and on the product to prevent physical harm to you or other people and damage to property. The symbols and their meanings are explained below.



This symbol indicates the risk of electric shock or fire danger that could result in injury or damage to equipment.

In order to protect against risk of electric shock, the installation should be properly grounded. Defeating the purpose of the grounding type plug will expose you to the risk of electric shock.

Disconnect the KOSMOS from the mains voltage before replacing a damaged fuse. Never bridge a fuse.



Possible risk of injury or damage to equipment.

Fire risk

The housing can reach high temperatures. Keep a safety distance of 0,25 m / 10" to adjacent surfaces on all sides of the fixture.

Do not cover the lamp head while using it. Proper ventilation must be provided on the upper ventilation slots and the bottom air filter.

Avoid exposing the lamp head to the heat radiation of other light fixtures.

Do not place the product on heat sources.

Do not power on the product if the ambient temperature exceeds 45° C.

Keep the cables away from the fixture.

High light beam intensity

The lamp head is equipped with power LED. Due to their high light-output intensity don't stare directly into the light source.

Do not open the product. Doing so will invalidate the product warranty.

Do not attempt to repair any part of the product on your own.

Maintenance and repair work to be carried out only by VELVET Service Centre.

Never connect the product to a dimmer system or a dimmer channel in non-dim mode. Doing so will damage the KOSMOS fixture electronics. Damages caused by connecting the product to a not suitable power source are not covered by the warranty.

Never point a light beam from another fixture into the light KOSMOS source.



Though the light generated by LED does not produce any heat, for what his use turns out to be very comfortable for the actors, the lamp head acts as a heat sink through its back part. Surface can reach a temperature between the 20°C and the 60°C. Please use protective gloves if you touch the lamp head at the heat sink.



This equipment has been checked and meets the requirements of general safety for electronic devices. These requirements are specified to provide a reasonable protection against electromagnetic interferences when the equipment is used in commercial environments.

This equipment generates, uses and can emit waves of radio frequency, and if not properly used following the instructions of this manual can produce interferences in radio communications. The use of this equipment in residential areas can produce interference, the user will be the only responsible of correcting them.

Table of contents

A	Main features	09
B	KOSMOS range models	11
C	KOSMOS 200 Bicolor	
	Parts	12
	Specifications	13
	Photometrics	14
D	KOSMOS 400 Bicolor	
	Parts	15
	Specifications	16
	Photometrics	17
E	KOSMOS Bicolor accessories	
	Rigging	18
	Spigots	18
	Beam Control	18
F	Power options	20
G	Placing into operation	
	Yoke to fixture assembling	21
	Pole Operate to fixture assembling	25
	Mounting and security	26
H	Accessories installation	
	Barndors installation	27
I	Diagrams / Sizes	30
J	Display introduction	
	Power on/off	32
	Display introduction	32
K	Functions settings	
	CCT Mode	33
	Dimming curves	34
	DMX	35
	Lumen Radio	36
	Fan mode	37

Ethernet	38
Zoom	39
About	40
Service	40
8 bits DMX map chart	41
16 bits DMX map chart	41
Kelvin DMX	42
Firmware updating	43

L KOSMOS maintenance and care	44
--	----

M Regulations	46
--------------------------------------	----

N Warranty	48
-----------------------------------	----

O QR links	50
-----------------------------------	----

Main features

Welcome

Thank you for selecting KOSMOS LED Fresnel from VELVET. The KOSMOS are compact Bicolor Fresnel producing unprecedented output with motorized ZOOM and total wireless control. KOSMOS are much more efficient than a traditional tungsten Fresnel and are the LED Fresnel efficiency market leaders.

The KOSMOS emit variable white light with adjustable color temperature, adjustable green/magenta correction and remotely controlled beam angle. Every KOSMOS model can be controlled using DMX-RDM protocol, Art-Net through Ethernet RJ-45 connectors or locally with an integrated digital display plus one rotary knob and quick user-friendly control and shock-proof buttons.

Control advantages

- You can locally or remotely adjust the beam angle with any control mode.
 - Any base white light color temperature between 2700 and 6500K can be set.
-

Electronic zoom

With KOSMOS you are entering on the digital beam control era. From 10° spot to 50° flood, digital beam control allows you to change the beam angle, mid-shot without manual adjustment. No hassle replacing fixed optics to have different beam angles.

With KOSMOS beam change is instant at your fingertips, local or remotely.

V4 ceramic light engine

VELVET Kosmos includes a state of the art VELVET proprietary super compact 35mm extended Bicolor + Green/Magenta light engine. A total of 200 custom Red, Green, Warm White and Cool White high-power LED are arranged over a ceramic substrate with a special distribution to produce a homogeneous beam of very powerful light.

The light engine compact diameter acts as a point source to produce sharp, single shadow light with bright and saturated colors. The finest quality custom Red and Green LED highly saturated colors allow a precise Green/Magenta correction while the high CRI Warm and Cool white LED produce a massive amount of white light over only color light engines.

3D chamber cooling system

Compactness comes from an extremely compact and lightweight cooling system designed by VELVET.

Every KOSMOS includes a passive liquid cooling system contained into a sealed 3D copper chamber with a silent fan protected by an air filter.

This advanced cooling system is controlled with three heat sensors and a variable speed silent fan to keep not only the light engine but also the electronics at the optimum temperature.

Glass fresnel lens

A true borosilicate glass Fresnel lens produces a traditional effect, consistently creating 10° to 50° single-shadow beam angles, clean color reproduction and ensuring years of reliable operation.

The big size of the lens produce a natural, hard and directional Fresnel light with the VELVET character to create real image

Total control built-in

KOSMOS Bicolor can be fullt, quickly and easily controlled in any possible way locally or remotely using the optional LumenRadio built-in receiver.

Wire control

DMX-RDM through XLR-5 in&out connectors and Art-Net through Ethernet with two RJ-45 connectors.

Local control

The digital display simplifies any light parameter or zoom while one rotary knobs provide precise manual adjustments.

- You can instantly reset to 3200K or 5600K white light without any other modified parameter.
-

KOSMOS range models

VK200BNY

VELVET Kosmos 200 Bicolor



VK400BNY

VELVET Kosmos 400 Bicolor



VELVET KOSMOS 200 Bicolor (Ref: VK200BNY)

PARTS



1. 2x handles and security cable attachment
2. USB connector
3. 2x PowerCon In & through connectors
4. 2x XLR-5 DMX In & Out connector
5. Antenna (Optional with Lumen Radio)
6. Digital display
7. Mode selection button
8. Zoom selection button
9. 3200K / 5600K quick access buttons
10. Rotary selector button
11. Main power switch
12. 2x RJ45 Ethernet connector



SPECIFICATIONS

OPTICAL SYSTEM	Motorized ZOOM Fresnel
LIGHT APERTURE	Borosilicate glass Fresnel lens 250mm / 10"
LIGHT ENGINE	25 mm Kelvin white light VELVET ceramic COB LED
COLOUR TEMPERATURE	Continuously adjustable from 2700K to 6500K
GREEN MAGENTA	Continuously adjustable from full Plusgreen to full Minusgreen
LIGHT INTENSITY	Dimmable 0 to 100, smooth and flicker-free
CONTROL	Local via rotary knob + display, 32K/ 56K button and Mode dedicated button. Wire DMX-RDM, Art-Net through Ethernet RJ-45 connectors and LumenRadio (optionally)
TLCI INDEX	94 at 3200K and 96 at 5600K
PHOTOMETRICS	Beam angle 45°: 3870 lux / 359 fc at 3m / 10 feet 1093 lux / 102 fc at 6m / 20 feet Beam angle 10°: 10700 lux / 994 fc at 3m / 10 feet 2635 lux / 245 fc at 6m / 20 feet
BEAM ANGLE	From 10° to 45°
DIMENSIONS (Without yoke)	290x534x167 mm / 11.42x21.02x6.57 inches
WEIGHT	9.1 kg/ 20 lbs (fixture) 9.6 kg/ 21.1 lbs (fixture + yoke)
POWER DRAW	230W (1.0A at 220VAC — 2.1A at 110VAC)
POWER SUPPLY	Build-in Power Supplu Unit. 90-264 50/60 Hz
LED RATED LIFE	More than 50.000 hours
POWER CONNECTION	Neutrik PowerCon TRUE1 TOP In&out connectors
OUTPUT FREQUENCY	Over 12,000 fps
OPERATION TEMPERATURE	From -20°C to +40°C
COOLING	Passive liquid cooling system into sealed 3D chamber with silent fan
PROTECTION	IP30, indoor or outdoor protected use
RIGGING OPTIONS	Aluminum yoke with 28mm junior pin, pole operated yoke.
QUICK MOUNTING ACCESSORIES	Removable Barn doors, Pole operatde Yoke, Filter frames
CONSTRUCTION & FINISH	Fixture and yoke made of die-cast aluminum

PHOTOMETRICS

DIAMETER	Ø 1,8m/ 5.9'		Ø 2,5m/ 8.2'		Ø 4,2m/ 13.7'	
	 45°	3530 lux 328 fc	2152 lux 199 fc	1449 lux 134 fc	966 lux 89 fc	724 lux 67 fc
3870 lux 359 fc		2341 lux 217 fc	1576 lux 146 fc	1093 lux 102 fc	814 lux 76 fc	604 lux 56 fc
DISTANCE	3m/ 9.8'	4m/ 13'	5m/ 16.4'	6m/ 19.6'	7m/ 23'	8m/ 26.2'

DIAMETER	Ø 0,6m/ 1.95'		Ø 1,5m/ 4.9'		Ø 2,1m/ 6.8'	
	 10°	9900 lux 920 fc	5775 lux 536 fc	3727 lux 346 fc	2362 lux 219 fc	1732 lux 161 fc
10700 lux 994 fc		6300 lux 585 fc	3990 lux 371 fc	2635 lux 245 fc	1932 lux 179 fc	1271 lux 118 fc
DISTANCE	3m/ 9.8'	4m/ 13'	5m/ 16.4'	6m/ 19.6'	7m/ 23'	8m/ 26.2'

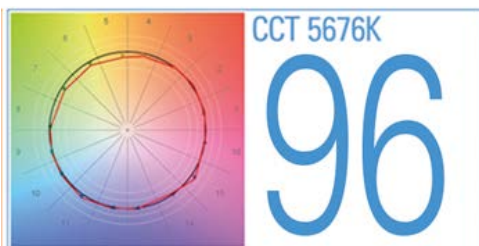
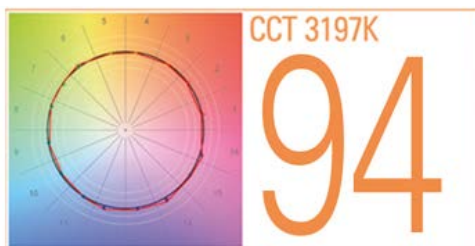

VELVET KOSMOS 400 Bicolor (Ref: VK400BNY)

PARTS



1. 2x handles and security cable attachment
2. USB connector
3. 2x PowerCon In & through connectors
4. 2x XLR-5 DMX In & Out connector
5. Antenna (Optional with Lumen Radio)
6. Digital display
7. Mode selection button
8. Zoom selection button
9. 3200K / 5600K quick access buttons
10. Rotary selector button
11. Main power switch
12. 2x RJ45 Ethernet connector



SPECIFICATIONS

OPTICAL SYSTEM	Motorized ZOOM Fresnel
LIGHT APERTURE	Borosilicate glass Fresnel lens 300mm / 12"
LIGHT ENGINE	35 mm Kelvin white light VELVET ceramic COB LED
COLOUR TEMPERATURE	Continuously adjustable from 2700K to 6500K
GREEN MAGENTA	Continuously adjustable from full Plusgreen to full Minusgreen
LIGHT INTENSITY	Dimmable 0 to 100, smooth and flicker-free
CONTROL	Local via rotary knob + display, 32K/ 56K button and Mode dedicated button. Wire DMX-RDM, Art-Net through Ethernet RJ-45 connectors and LumenRadio (optionally)
TLCI INDEX	94 at 3200K and 96 at 5600K
PHOTOMETRICS	Beam angle 50°: 4200 lux / 391 fc at 3m / 10 feet 1103 lux / 102 fc at 6m / 20 feet Beam angle 13°: 17325 lux / 1610 fc at 3m / 10 feet 4478 lux / 416 fc at 6m / 20 feet
BEAM ANGLE	From 13° to 50°
DIMENSIONS (Without yoke)	320x534x167mm / 12.60x21.02x6.57 inches
WEIGHT	9.3 kg/ 20.5 lbs (fixture) 9.8 kg/ 22.6 lbs (fixture + yoke)
POWER DRAW	400W (1.8A at 220VAC — 3.7A at 110VAC)
POWER SUPPLY	Build-in Power Supplu Unit. 90-264 50/60 Hz
LED RATED LIFE	More than 50.000 hours
POWER CONNECTION	Neutrik PowerCon TRUE1 TOP In&out connectors
OUTPUT FREQUENCY	Over 12,000 fps
OPERATION TEMPERATURE	From -20°C to +40°C
COOLING	Passive liquid cooling system into sealed 3D chamber with silent fan
PROTECTION	IP30, indoor or outdoor protected use
RIGGING OPTIONS	Aluminum yoke with 28mm junior pin, pole operated yoke.
QUICK MOUNTING ACCESSORIES	Removable Barn doors, Pole operatde Yoke, Filter frames
CONSTRUCTION & FINISH	Fixture and yoke made of die-cast aluminum

PHOTOMETRICS

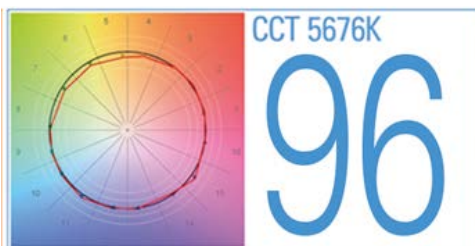
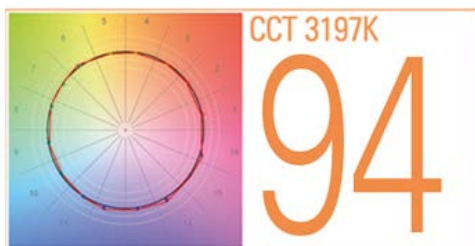
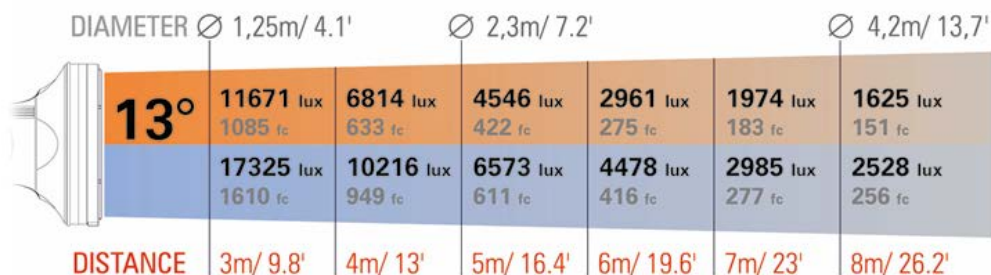
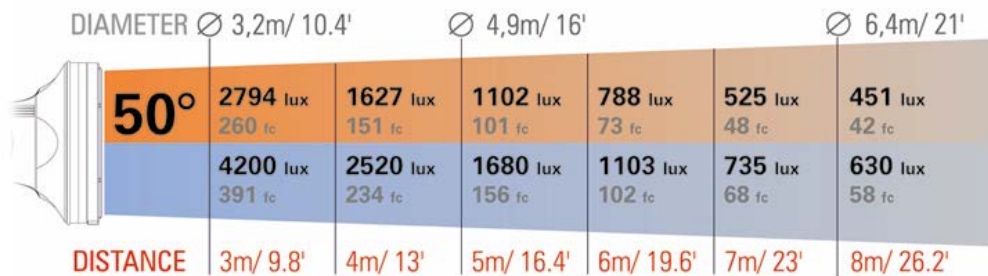

KOSMOS Bicolor accessories

RIGGING

VK42-YTK

Tubular yoke for VK200BNY and VK400BNY without spigot.



VK42-YPO

Pole Operated yoke kit for for VK200BNY and VK400BNY with 28mm Junior pin.



SPIGOTS

EV-EURO28TKC

Euro28mm. junior pin for tube yoke with square insert



BEAM CONTROL

VK400-RB

KOSMOS 400 4 folding barndoors kit



VK400-RB8

KOSMOS 400 8 folding
barndoors kit



VK400-FF

KOSMOS 400 filter frame



REMOTE CONTROL

VK-LR

LumenRadio (optional)



Power options

POWER OPTIONS

AC POWER 90 to 264 VAC

The KOSMOS Bicolor Series can be exclusively powered by AC power. Connect the power cable to the PowerCon TRUE1 TOP and the power plug with a mains power outlet.



High light beam intensity: The lamp head is equipped with power LED. Due to their high light-output intensity don't stare directly into the light source.

Always connect the KOSMOS direct to AC power. Do not connect the fixture to a dimmer system. Doing so will damage the fixture.



Grounding: In order to protect against risk of electric shock, the AC installation should be properly grounded. The AC mains power supply must be fitted with a fuse or circuit breaker and ground-fault (earth-fault) protection. Defeating the purpose of the grounding type plug will expose you to the risk of electric shock.

Placing into operation

YOKE TO FIXTURE ASSEMBLING

VK42-YT / Tubular yoke for VK200BNY and VK400BNY without spigot.

+

EV-EURO28TKC / Euro28mm. junior pin for tube yoke with square insert

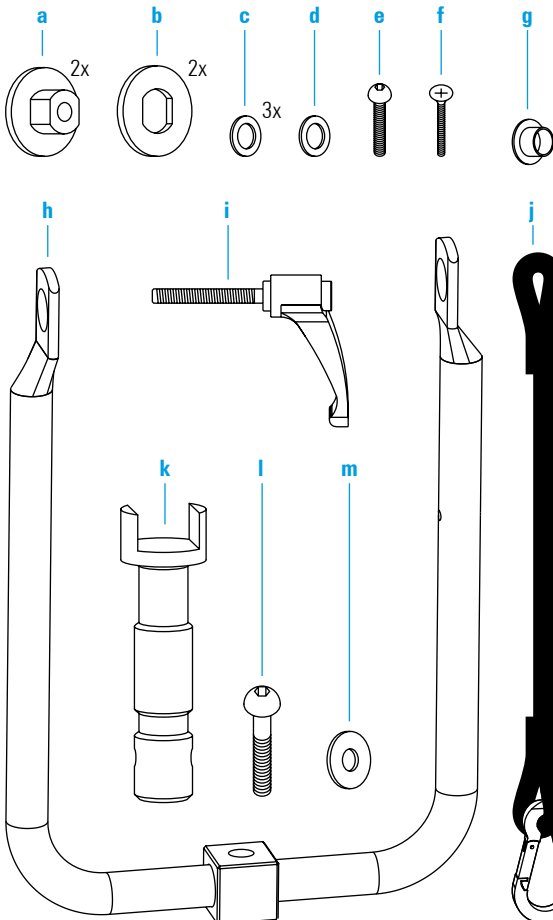

Yoke assembling pieces

- a. **M4300P17S000** Nylon side bushing for KOSMOS yoke
- b. **TOR-KWS** Ferodo washer for KOSMOS yoke
- c. **TOR-D2093BM8T** Conical M8 washer
- d. **TOR-D125M8T** Black M8 standard washer
- e. **TOR-D7380M8X30T** Allen socket head cap screw M80x30
- f. **TOR-D965M5X30T** BlackPhillips countersunk screw M5x30
- g. **TOR-D466M5** Knurled nut high form M5
- h. **M4300P100000** KOSMOS tubular yoke with squared stud
- i. **M3800P190000** KOSMOS adjustable knob M8x30
- j. **M4300P560002** Nylon safety cable for KOSMOS yoke

Spigot assembling pieces

- k. **EV-EURO28TC** Spigot Euro 28mm/junior pin for tubular yoke
- l. **TOR-D7380M8X40T** Allen socket head cap screw M8x40
- m. **TOR-DIN9021M8T** Metallic M8 washer

Steps scheme

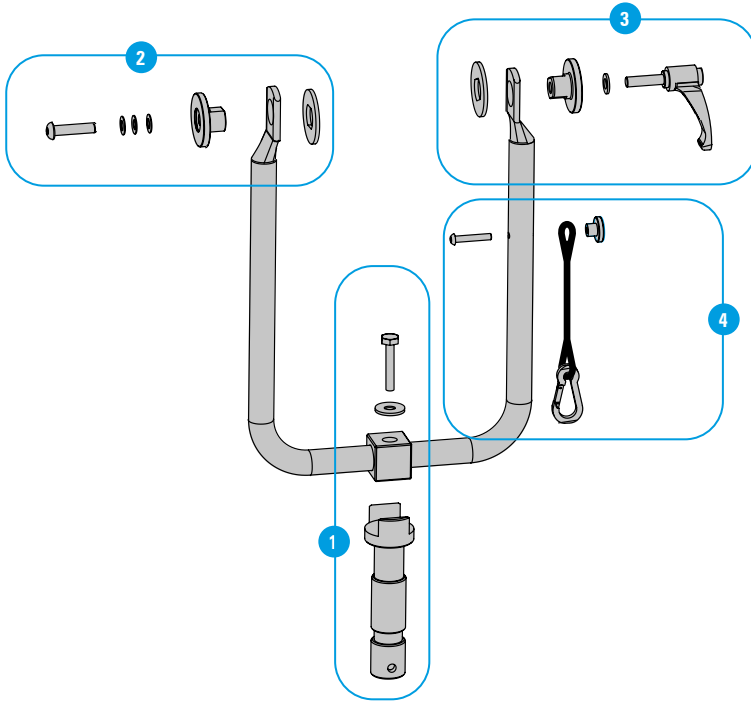

STEP 1

Spigot assembling

Use a mallet or hammer to press the spigot (k) into the square housing of the tubular yoke (h). Secure the assembly with the washer (m) and screw (l).

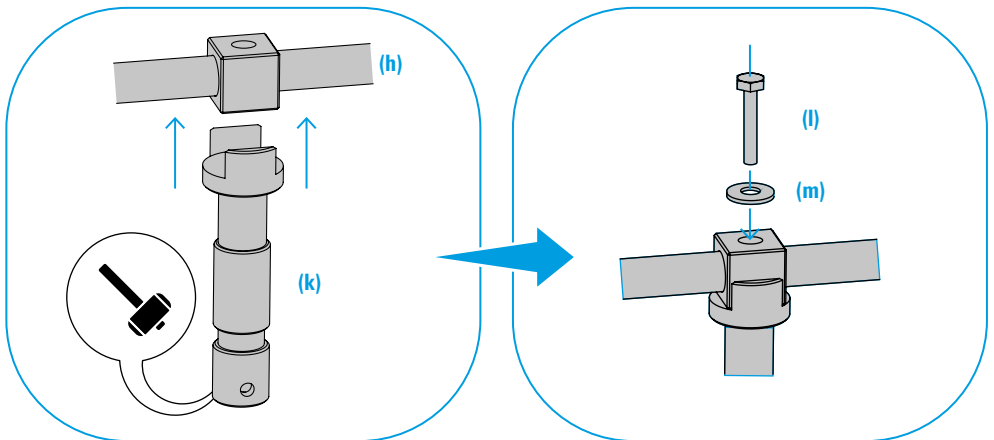

STEP 2

Yoke assembling

Place the ferodo washer **(b)** on the inside of the yoke **(h)**. Place the side bushing **(a)** and the three conical washers **(c)** on the outside and use the allen screw **(e)** to fix the parts with the fixture and select the desired friction.

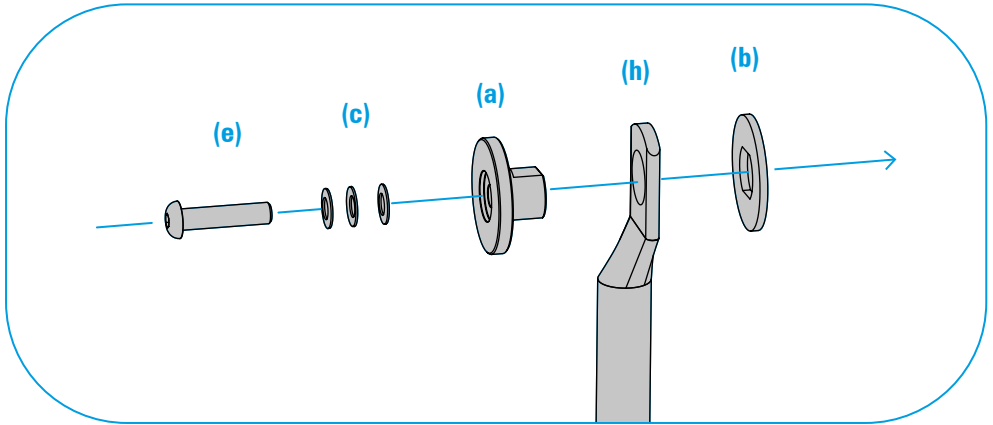
STEP 3

Yoke assembling

Place the ferodo washer **(b)** on the inside of the yoke **(h)**. Place the side bushing **(a)** and the standard washer **(d)** on the outside and use the adjustable handle **(i)** to fix the parts with the fixture.

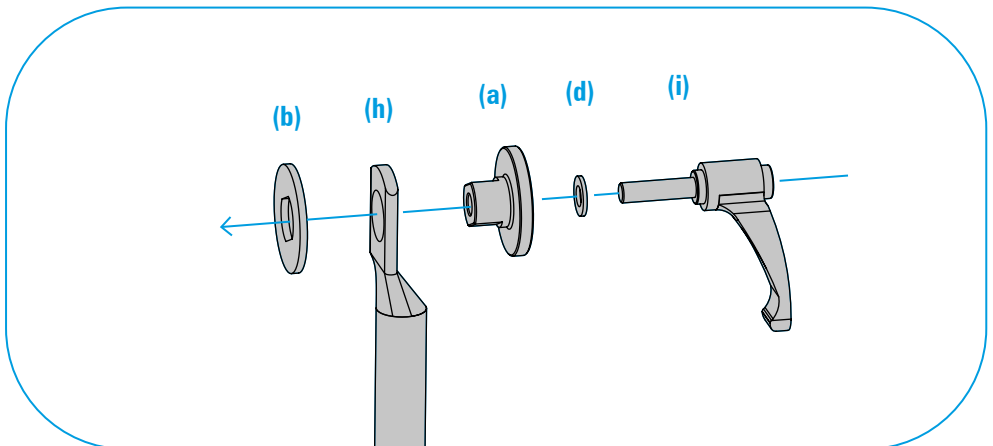

STEP 4

Safety cable

Use the screw **(f)** on the inside of the yoke and the knurled nut **(g)** on the outside to attach the safety cable **(j)** to the yoke.

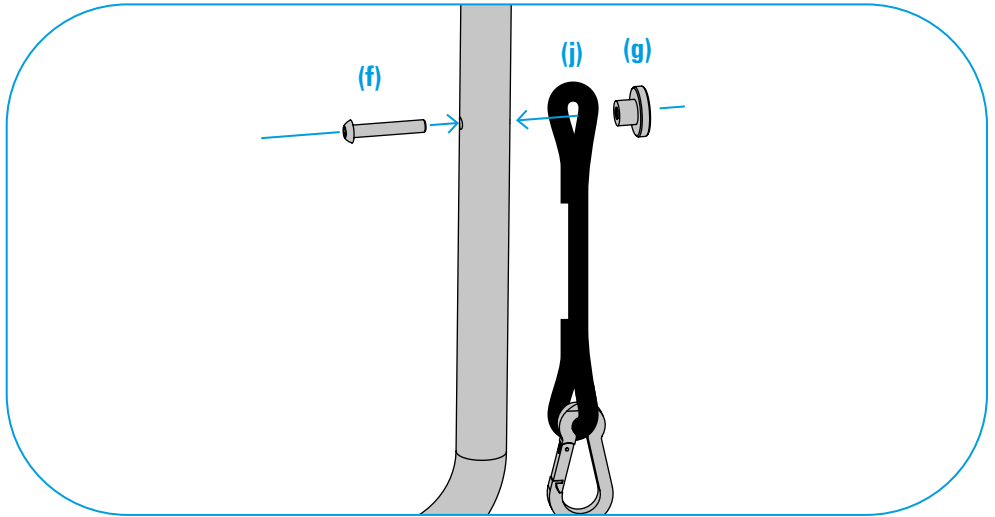

POLE OPERATED YOKE TO FIXTURE ASSEMBLING

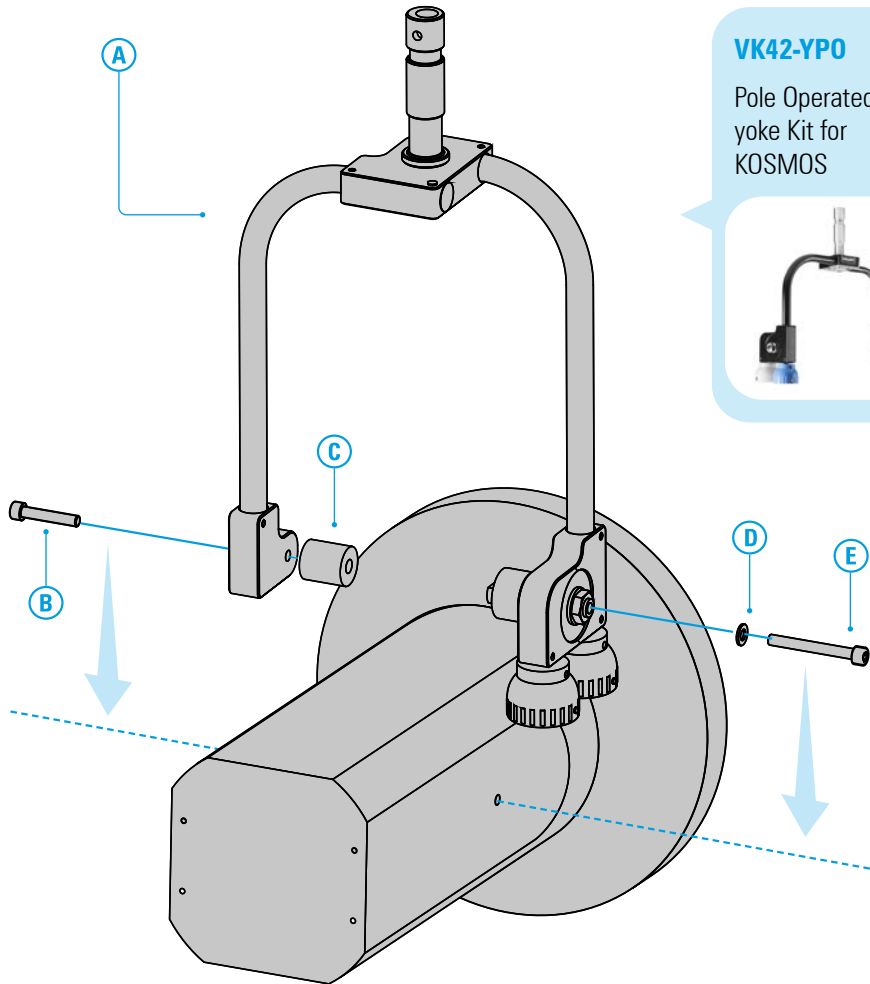

Reference	Amount	Description
A M4300P480000	1	Pole Operated yoke for KOSMOS 200 and KOSMOS 400
B TOR-I7379M8X45	1	ISO-7379 M8x45 allen screw
C Q4300P17000	1	30-10,5-34,5 nylon spacer bushing for KOSMOS Pole Operated yoke
D TOR-D125M8	1	DIN125 M8 Silver standard washer
E TOR-D912M8X100	1	DIN912 M8x100 allen screw

MOUNTING AND SECURITY

VELVET Kosmos fixtures have been designed to be easily installed and rigged up on studio, special locations and vehicles.



When a VELVET Kosmos and any other component is mounted in a hanging position it must be secured with a safety cable rated at a minimum of ten times the weight of the light fixture including its accessories.

Secure the KOSMOS with a safety cable from the mounting structure or truss through the fixture yoke.

Accessories installation

BARNDOORS INSTALLATION

VK400-RB

KOSMOS 400 4 folding barndoors kit

VK400-RB8

KOSMOS 400 8 folding barndoors kit



STEP 1

Loosen the top movable bracket and turn the piece 90° to make it easier to insert the accessory.



STEP 2

Insert the barndoor vertically, parallel to the Fresnel lens, and place it in the outer guides. The inner guides should remain clear for the optional filter holder.



STEP 3

Adjust the movable bracket to engage with the barndoor frame.
Tighten the wing nut to fully secure the accessory.



Diagrams / Sizes

VELVET KOSMOS 200 Bicolor + M0 Yoke

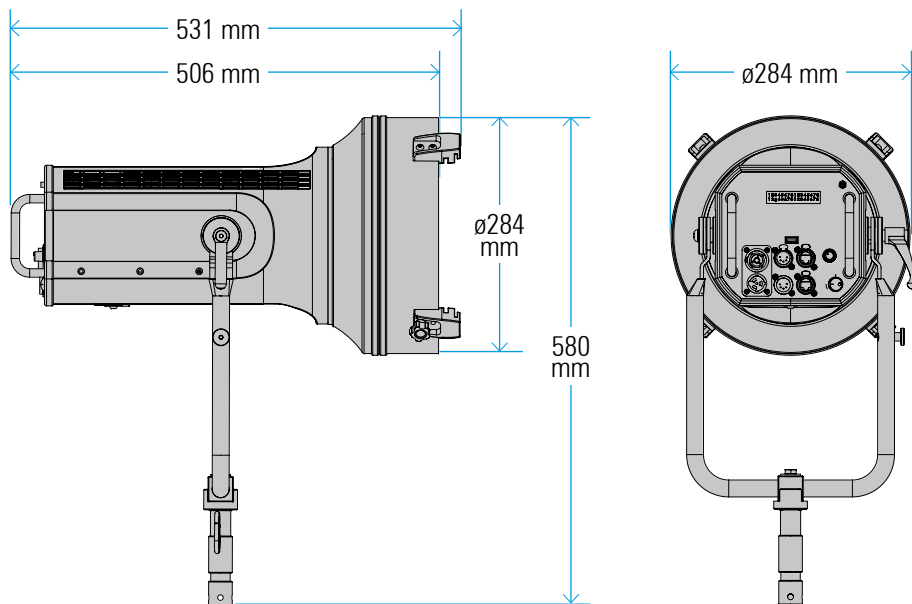

VELVET KOSMOS + P0 Yoke

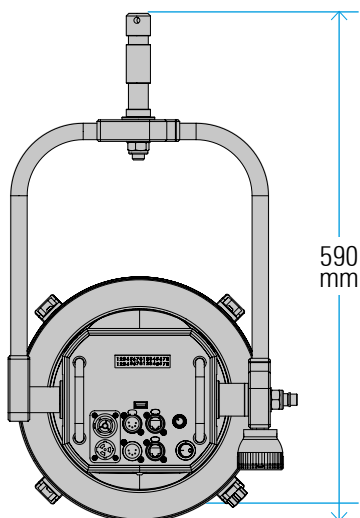

VELVET KOSMOS 400 Bicolor + MO Yoke

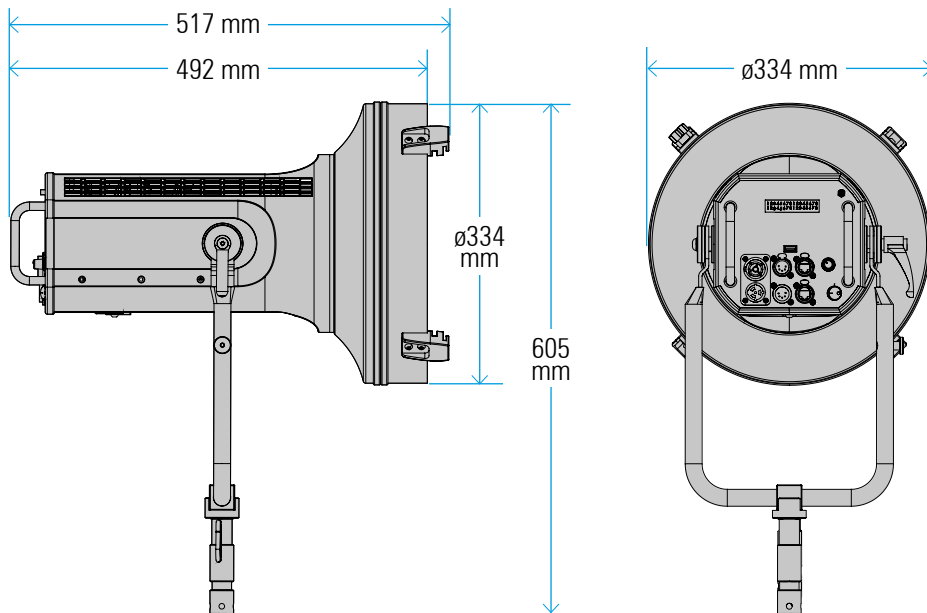

VELVET KOSMOS + PO Yoke

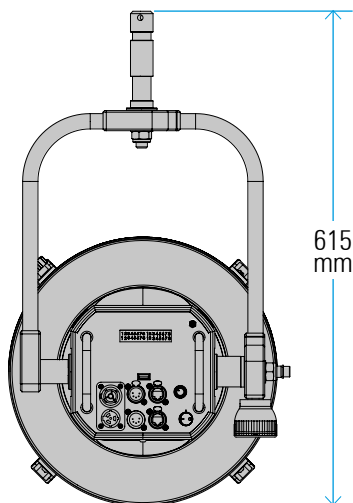

Display introduction

POWER ON/OFF

After switching on the KOSMOS initializes for a few seconds to be ready for operation through digital display plus the rotary knob.



High light beam intensity: The lamp head is equipped with power LED. Due to their high light-output intensity don't staredirectly into the light source.

DISPLAY INTRODUCTION

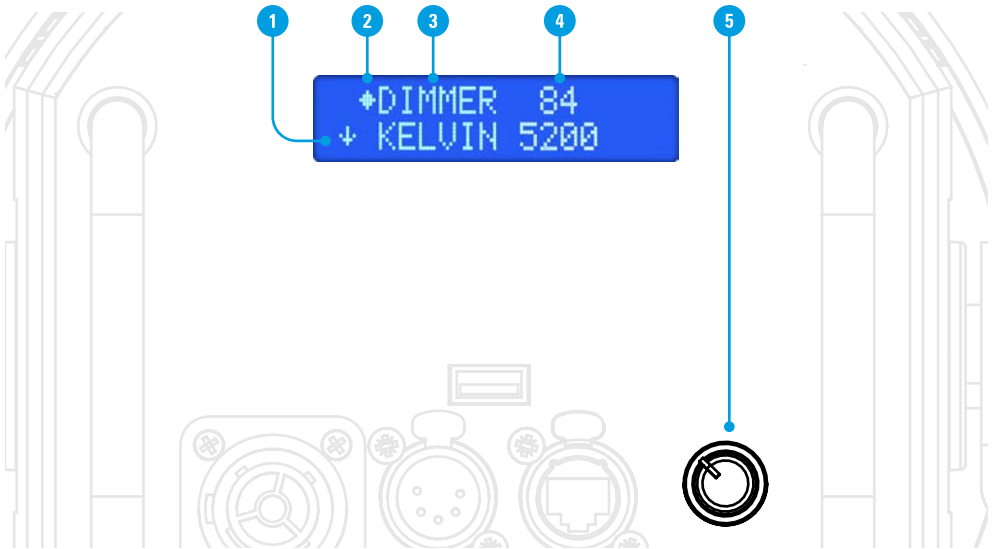

- 1. ARROW INDICATOR** Indicates that the current screen contains additional values, modes, or settings. Rotate the knob to scroll through the list in the direction of the arrow.
- 2. POINTER** The Pointer cursor indicates the current option, parameter, or value. Rotate the knob to move the cursor through the list or to adjust parameter values.
- 3. MODES / PARAMETERS** Displays the current menu item, parameter, or adjustable value. Use the rotary knob to interact with the selection.
- 4. VALUE** Once a setting or parameter is selected, the pointer moves to the value. This value may appear as a numerical setting or a text-based option.
- 5. ROTARY KNOB**
 1. Manually and precisely adjust the selected option /
 2. Press to toggle among selectable options

Functions settings

CCT MODE

1. In the main menu, turn the knob until the pointer is next to CCT MODE option.
2. Press the knob to enter and customize CCT MODE parameters.

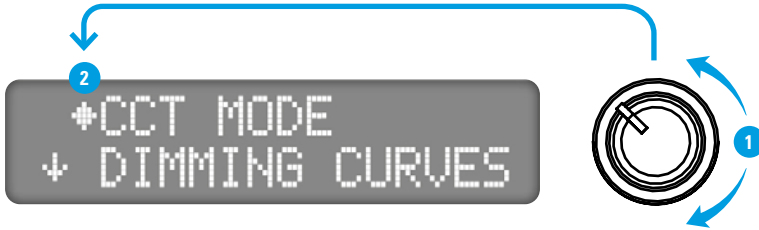

DIMMER / KELVIN / GREEN MAGENTA

1. Align the pointer besides the DIMMER / KELVIN / GREEN MAGENTA title.
2. Press the knob button to customize the parameter value.

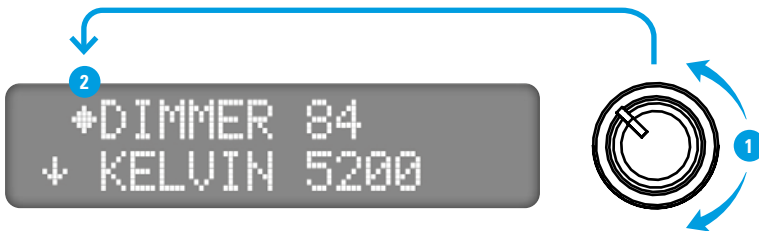

3. Once the pointer moves to the value, rotate the knob to increase or decrease the setting.
4. Press the knob again to confirm and save the value.

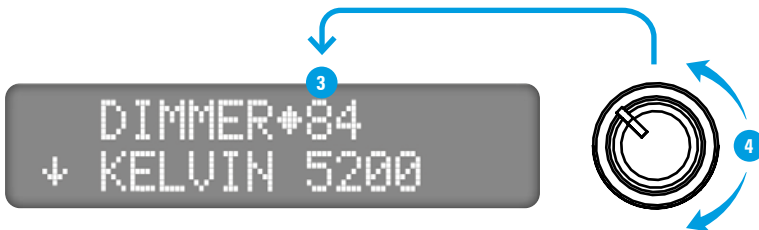

BACK

Align the pointer beside the BACK option and press the knob to return to the Main Menu.

DIMMING CURVES

1. In the main menu, turn the knob until the pointer is next to DIMMING CURVES option.
2. Press the knob to enter and customize DIMMING CURVES parameters.

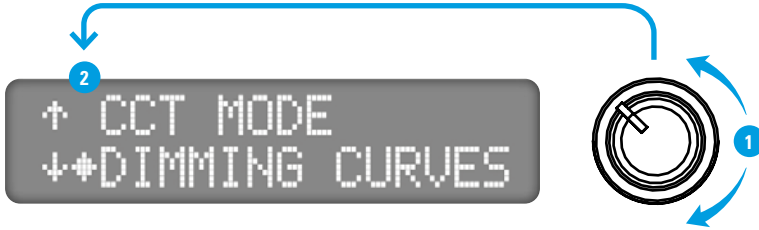

LIN / LOG / EXP

1. Align the pointer besides the CURVE title.
2. Press the knob button to customize the parameter value.



3. Once the pointer moves to the value, rotate the knob to select between
LIN = Lineal
LOG = Logarithmic
EXP = Exponential
3. Press the knob again to confirm and save the value.

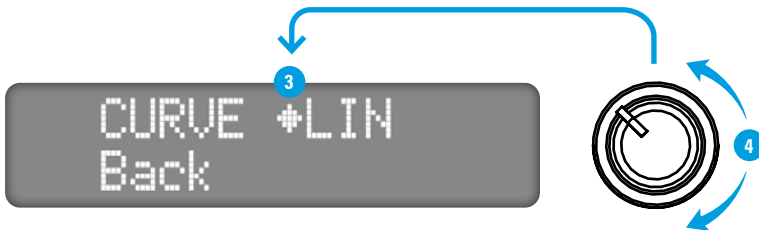

BACK

Align the pointer besides the BACK option and press the knob to return to the Main Menu.

DMX

1. In the main menu, turn the knob until the pointer is next to DMX option.
2. Press the knob to enter and customize DMX parameters.



BITS / STA / ADRESS / LAST_CMD

1. Align the pointer next to the parameter you wish to modify.
2. Press the knob button to customize the parameter value.

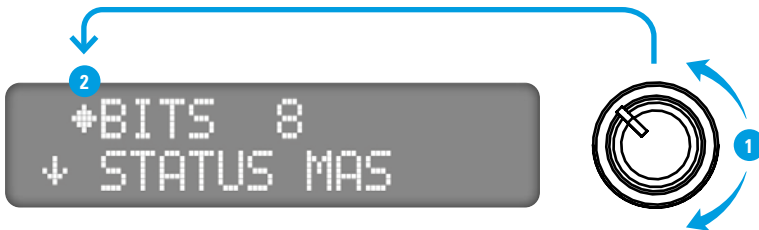

3. Once the pointer moves to the value, rotate the knob to modify it.

BITS = 8 / 16 bits

STA (Status) = MAS (Master) / SLA (Slave)

ADRESS = Value from 1 to 512

LAST_CMD (Last comand) = 0 / 1

4. Press the knob again to confirm and save the value.

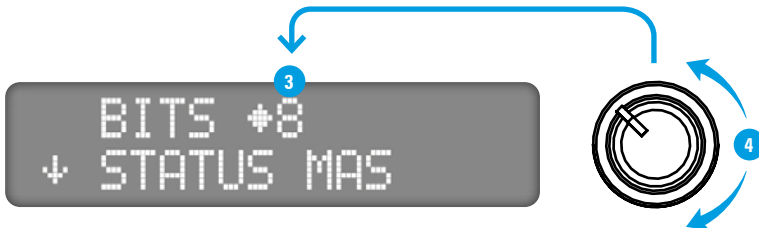

BACK

Align the pointer beside the BACK option and press the knob to return to the Main Menu.

LUMEN RADIO

1. In the main menu, turn the knob until the pointer is next to LUMEN RADIO option.
2. Press the knob to enter and customize LUMEN RADIO parameters.



HOW TO LINK A LUMEN RADIO DEVICE?

1. Wait for the KOSMOS to detect the nearest Lumen Radio device. During the search process, the message **Waiting** will appear on the screen.
2. Once the connection is established, the screen displays the text **Linked**.

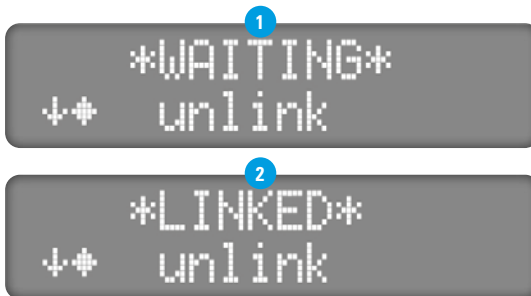

HOW TO UNLINK A LUMEN RADIO DEVICE?

1. Turn the knob until the pointer is next to UNLINK option.
2. Press the knob to unlink the device.



BACK

Align the pointer beside the BACK option and press the knob to return to the Main Menu.

FAN MODE

1. In the main menu, turn the knob until the pointer is next to FAN MODE option.
2. Press the knob to enter and customize FAN MODE parameters.



DYNAMIC / SILENCE / FULL SPEED / OFF

1. Align the pointer besides the main title.
2. Press the knob button to customize the parameter value.
3. Rotate the knob to select between
 - DYNAMIC**
 - SILENCE**
 - FULL SPEED**
 - OFF**
4. Press the knob again to confirm and save the value.

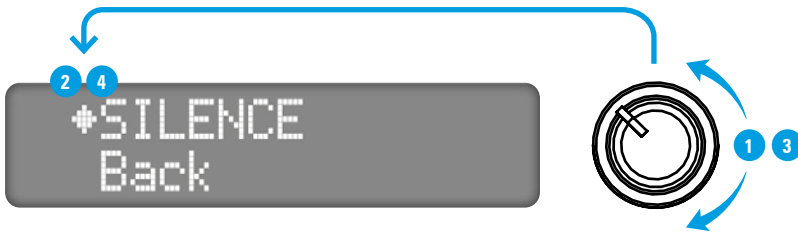

BACK

Align the pointer beside the BACK option and press the knob to return to the Main Menu.

ETHERNET

1. In the main menu, turn the knob until the pointer is next to ETHERNET option.
2. Press the knob to enter and customize ETHERNET parameters.



IP MODE / CONNECT / IP / MAC / UNIVERSE

1. Align the pointer next to the parameter you wish to modify.
2. Press the knob button to customize the parameter value.

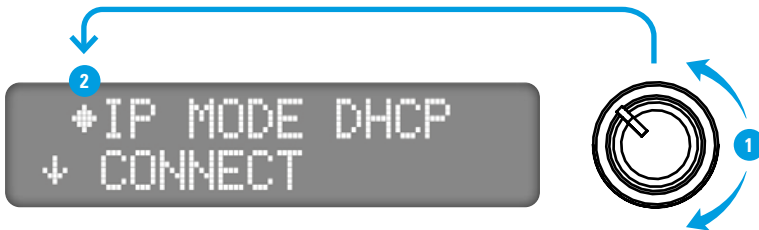

3. Once the pointer moves to the value, rotate the knob to modify it.

IP MODE = DHCP / 10.X / 2.X

CONNECTED / UNCONNECTED

IP = When KOSMOS is connected to a network it shows the fixture IP address.

MAC (4CC382905E93) = When KOSMOS is connected to a network it shows the fixture MAC address.

UNIVERSE = Value from 0 to 999

4. Press the knob again to confirm and save the value.



BACK

Align the pointer beside the BACK option and press the knob to return to the Main Menu.

ZOOM

1. In the main menu, turn the knob until the pointer is next to ZOOM option.
2. Press the knob to enter and customize ZOOM parameters.



ZOOM ANGLE

1. Align the pointer next to the parameter you wish to modify.
2. Press the knob button to customize the parameter value.

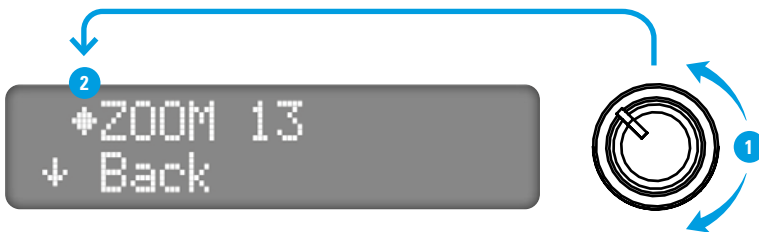

3. Once the pointer moves to the value, rotate the knob to modify it.
KOSMOS 200 Bicolor = Zoom angle from 10° to 45°
KOSMOS 400 Bicolor = Zoom angle 13° to 50°
4. Press the knob again to confirm and save the value.

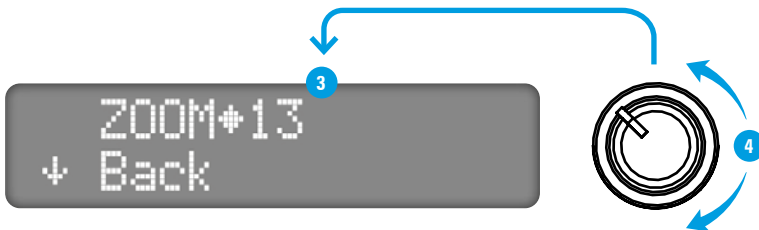

BACK

Align the pointer beside the BACK option and press the knob to return to the Main Menu.

ABOUT

1. In the main menu, turn the knob until the pointer is next to ABOUT option.
2. Press the knob to enter and visualize the ABOUT section information.



NOTE

The 'About' section shows important information regarding the fixture and does not allow for the configuration of any parameters.

- **MAIN FWR Vxxx** = The current firmware version installed on the fixture.
- **ETH FWR Vxxx** = The current Ethernet firmware version installed on the fixture.
- **SN** = Fixture Identification Number
- **OP_HOURS** = Fixture operating hours
- **COB_HOURS** = Light engine operating hours
- **BACK** = Align the pointer beside the BACK option and press the knob to return to the Main Menu.

SERVICE

1. In the main menu, turn the knob until the pointer is next to SERVICE option.
2. Press the knob to access the SERVICE function.

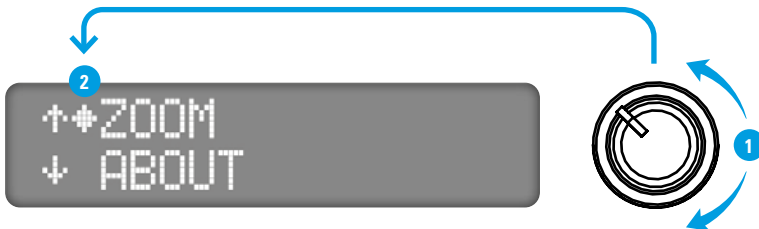

NOTE

Service menu is an exclusively factory mode only accessible to VELVET technicians through a code

BACK

Align the pointer beside the BACK option and press the knob to return to the Main Menu.

8 bits DMX MAP CHART (Firmware V01_01)

KOSMOS BICOLOR DMX MAP 8 bits (Firmware V01_01)							
Mode Number	Mode Name	Channel	Function	Value	KOSMOS range		
1	CCT (5 channels)	1	Master intensity	0-255	0-100		
		2	Kelvin	0-255	2500K to 10000K		
		3	Green / Magenta	0 = Neutral 1-121 = 100M to 1 M 122-132 = Neutral zone 133-255 = 1G to 100G	100M to 100G		
		4	ZOOM	0-255	VK200BNY = 10°-45° VK400BNY = 13°-56°		
		5	FAN	0-9 = Silence			Fan speed according to LED temperature. Maximum power priority.
				10-19 = Dynamic			Fan speed according to LED temperature. Maximum power priority.
				20-29 = Full Speed			Fan operates at maximum power.
				30-39 = Fan Off			Fan only operates in the limit to protect the LED. Maximum power might be reduced and light switched off.
				>39 = Reserved for future use			

16 bits DMX MAP CHART (Firmware V01_01)

KOSMOS BICOLOR DMX MAP 16 bits (Firmware V01_01)							
Mode Number	Mode Name	Channel	Function	Value	KOSMOS range		
1	CCT (5 channels)	1	Master intensity Course	0-255	0-65535		
		2	Master intensity Fine	0-255	0-100		
		3	Kelvin	0-255	2500K to 10000K		
		4	Green / Magenta	0 = Neutral 1-121 = 100M to 1 M 122-132 = Neutral zone 133-255 = 1G to 100G	100M to 100G		
		5	ZOOM	0-255	VK200BNY = 10°-45° VK400BNY = 13°-56°		
		6	FAN	0-9 = Silence			Fan speed according to LED temperature. Maximum power priority.
				10-19 = Dynamic			Fan speed according to LED temperature. Maximum power priority.
				20-29 = Full Speed			Fan operates at maximum power.
				30-39 = Fan Off			Fan only operates in the limit to protect the LED. Maximum power might be reduced and light switched off.
				>39 = Reserved for future use			

KELVIN DMX (Firmware V01_05)

Dmx value (0 - 255) MIN. VALUE RANGE	Dmx value (0 - 255) MIN. VALUE RANGE	Percentage (0% - 100%)	KELVIN (2700K - 6500K)
0	6	0%	2700K
7	13	3%	2800K
14	19	5%	2900K
20	26	8%	3000K
27	32	11%	3100K
33	39	13%	3200K
40	45	16%	3300K
46	52	18%	3400K
53	58	21%	3500K
59	65	23%	3600K
66	71	26%	3700K
72	78	28%	3800K
79	84	31%	3900K
85	91	33%	4000K
92	98	36%	4100K
99	104	39%	4200K
105	111	41%	4300K
112	117	44%	4400K
118	124	46%	4500K
125	130	49%	4600K
131	137	51%	4700K
138	143	54%	4800K
144	150	56%	4900K
151	156	59%	5000K
157	163	62%	5100K
164	169	64%	5200K
170	176	67%	5300K
177	183	69%	5400K
184	189	72%	5500K
190	196	75%	5600K
197	202	77%	5700K
203	209	80%	5800K
210	215	82%	5900K
216	222	85%	6000K
223	228	87%	6100K
229	235	90%	6200K
236	241	93%	6300K
242	248	95%	6400K
249	255	98%	6500K

FIRMWARE UPDATING

Copy the KOSMOS update file to the root of an USB memory stick.

1. Power on the KOSMOS
2. Connect the USB memory stick to the USB connector of the KOSMOS back panel
3. The KOSMOS will automatically start the update process.
4. Once the firmware update process is finished the KOSMOS will reboot with the new firmware and you can remove the USB memory stick.

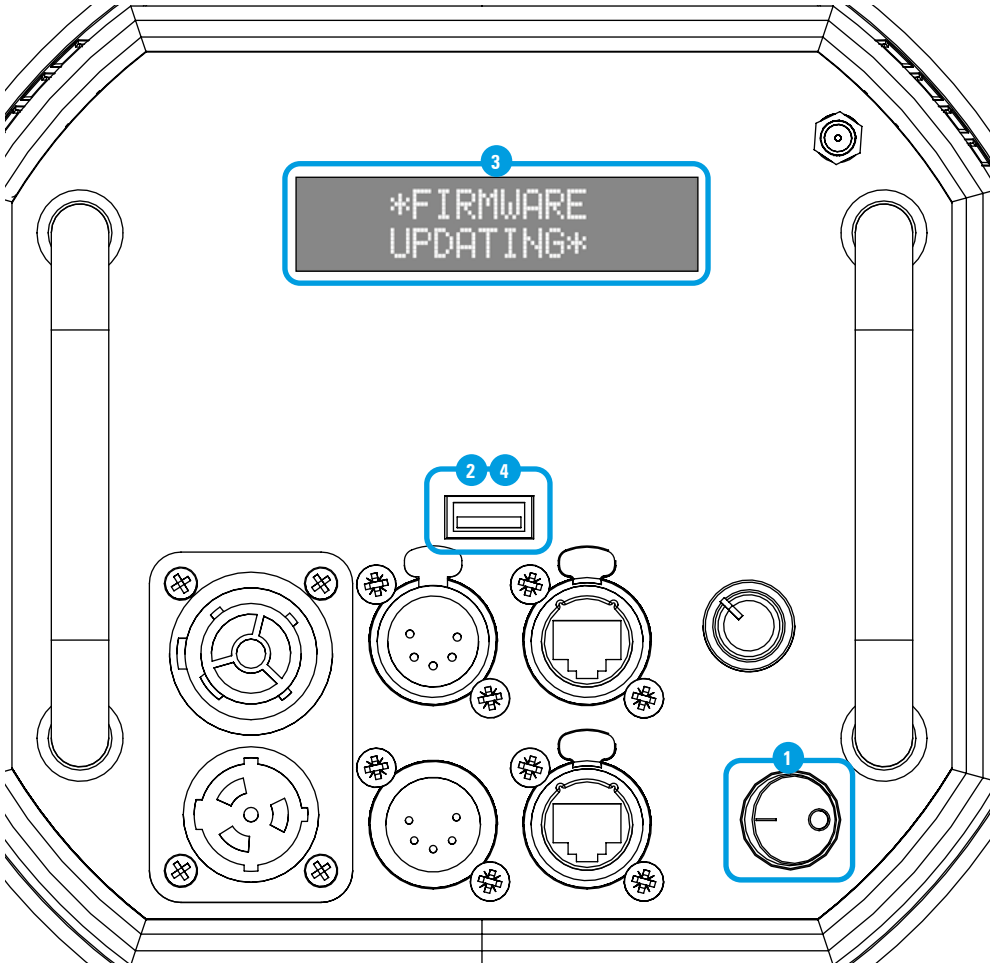

A visual inspection should be conducted before every use, and an inspection of electrical safety should be conducted at least once every 12 months.

Do not clean the fixture with solvents or strong detergents.

Clean the product with a soft cloth wetted with a mild detergent. Do not rub the surface: lift stuck particles off with a soft repeated press.

KOSMOS fixture require very little routine maintenance, if any. The cooling fan and electronics are protected by a special filter to refrain dust to enter into the fixture.

HOW TO CLEAN THE FAN FILTER

Unplug the device from power and let it cool down for a few minutes, if it has been on.

Remove the locking screw of the protection grille and then the fan filter from the bottom of the equipment.

Clean the filter using a vaccum cleaner.

Follow the reverse process to reassemble the filter, its protection grid and the locking screw.

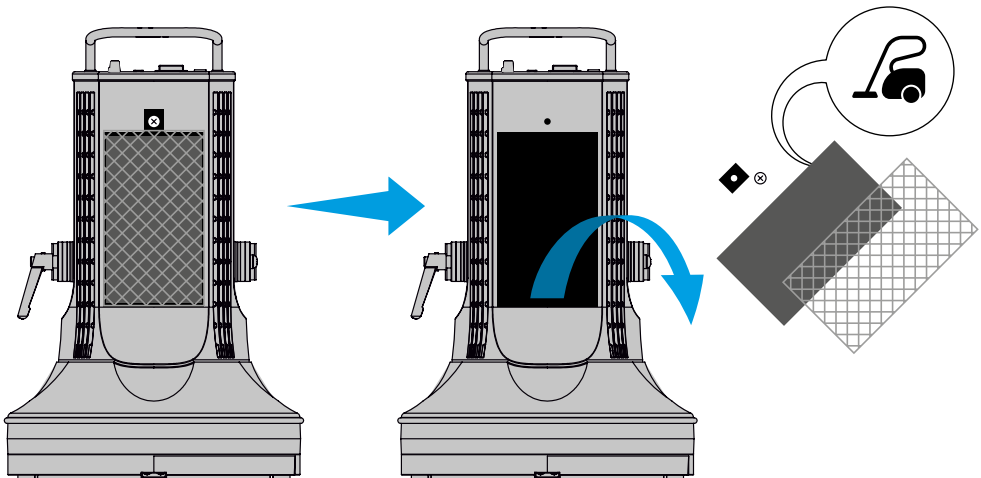

HOW TO CLEAN THE INSIDE OF KOSMOS

Clean the glass Fresnel lens with a soft, damp cloth.

Carefully clean the LED light engine lens and reflector with isopropyl alcohol and a cotton swab.

Clean the electrical contacts with cotton swabs dipped in isopropyl alcohol.

Keep the electrical contacts clean and replace oxidized parts.

Regulations

This equipment is designed to meet the following regulations and safety standards for battery powered technology equipment:

Environmental

Devices are certified and intended for indoor or outdoor use.

LAMP HEAD OPERATION TEMPERATURE from -20° to $+40^{\circ}$ C

OPERATING HUMIDITY from 30 to 90% RH non condensing

DECLARATION OF CONFORMITY TO EMC DIRECTIVE 2004/108 EC

Manufacturer name & adress

VELVET (THELIGHT luminary for cine and tv, S.L.)

Carrer de la Cerdanya 11-A.

08192 Sant Quirze del Vallés. BARCELONA, SPAIN.

info@velvetlight.tv / www.velvetlight.tv

Standards

EC - DECLARATION OF CONFORMITY

Brand Name: VELVET

Product Description: LED Luminaire systems for professional use

VELVET Kosmos

VELVET Evo1, Evo2, Evo 2x2

VELVET Cyc3, Cyc4, Cyc5, Cyc6

VELVET Mini 1, Mini 2, Mini 3

VELVET Mini Power 1, Mini Power 2

VELVET Light 1, Light 2, Start 2, Light 2x2, Light 4

VELVET Power 1, Power 2, Power 2x2

VELVET Sword 2, Sword 4.

The above products abide by the following European Directives:

DIRECTIVE 2014/30/EU of the European Parliament and of the Council of 26 February 2014 on the harmonization of the laws of the Member States relating to electromagnetic compatibility.

DIRECTIVE 2014/35/EU of the European Parliament and of the Council of 26 February 2014 on the harmonization of the laws of the Member States relating to the making available on the market of electrical equipment designed for use within certain voltage limits.

DIRECTIVE 2001/95/EC of the European Parliament and the Council of 3 December 2001 on general product safety.

DIRECTIVE 2011/65/EU of the European Parliament and of the Council of 8 June 2011 on the restriction of the use of certain hazardous substances in electrical and electronic equipment.

In compliance with the harmonized standards:

IEC 60598-1:2014 Luminaires - Part 1: General requirements and tests.

IEC 60598-1-17:2017 Luminaires - Part 2-17: Particular requirements - Luminaires for stage lighting, television and film studios (outdoor and indoor).

IEC 62031:2008/A1:2012 LED modules for general lighting - Safety specifications.

IEC 61547:2009 Equipment for general lighting purposes - EMC immunity requirements.

IEC 61000-6-1:2005 Electromagnetic compatibility (EMC) - Part 6-1: Generic standards - Immunity for residential, commercial and light-industrial environments.

IEC 61000-6-3:2006/A1:2010 Electromagnetic compatibility (EMC) - Part 6-3: Generic standards - Emission standard for residential, commercial and light-industrial environments.

IEC 61000-6-4:2006/A1:2010 Electromagnetic compatibility (EMC) - Part 6-4: Generic standards - Emission standard for industrial environments.

EN 301489-1 V1.8.1 Electromagnetic compatibility and Radio spectrum Matters (ERM); Electromagnetic Compatibility (EMC) standard for radio equipment and services; Part 1: Common technical requirements.

IEC 62493:2009 Assessment of lighting equipment related to human exposure to electromagnetic fields.

EN 55015:2013 Limits and methods of measurement of radio disturbance characteristics of electrical lighting and similar equipment.

RED 2014/53/EU Radio equipment directive.

EN 62471:2008 Photobiological Safety of Lamps and Lamp Systems.

Sant Quirze del Vallés. BARCELONA, 1 June 2021
Administrator - Javier Fdez. de Valderrama



Warranty

General warranty

VELVET LED light equipments are guaranteed to be free from defects in workmanship and parts in a warranty period of three (3) years from the date of purchase. Defects that occur within this warranty period, under normal use and care will be repaired or replaced at VELVET discretion, solely at our option with no charge for parts or labour.

In the event of the equipment malfunction, contact the dealer from which you purchased the product. Please note that you will be not be reimbursed for the cost of bringing the equipment to the VELVET Repair Centre.

VELVET reserves the right to replace the product or relevant part with the same or equivalent product or part, rather than repair it. Where a replacement is provided the products or part replaced becomes the property of VELVET. VELVET may replace parts with refurbished parts. Replacement of the product or a part does not extend or restart the Warranty period.

Return policy

Returns or exchanges from the customers will be accepted within 15 days of delivery and will not include the actual shipping costs. Item(s) must be in original packaging and condition, must not be assembled, and must include its original user manual.

This warranty does not cover any damage resulting from:

- Failure to follow the instructions in the instruction manual Repair, modification or overhaul not conducted by any authorized VELVET personnel.
- Fire, natural disaster, act of God, lightning, abnormal voltage, etc;
- Submergence in water (flooding), exposure to alcohol or other beverages, infiltration of sand or mud, physical shock, or dropping of the equipment and other unnatural causes.

This warranty only applies to the LED panel and not to the accessories, such as barn doors or mounts.

Any consequential damages arising from failure of the equipment, such as expenses incurred in taking pictures or recording images or loss of expected profit, will not be reimbursed whether they occur during the warranty period or not.

Parts essential to the servicing of the light equipment (that is, components required to maintain the functions and quality of the fixture) will be available for a period of five years after the product is discontinued.

THELIGHT Luminary for cine and tv, S.L.

www.velvetlight.tv

The total or partial reproduction of this guide is prohibited without the express written permission of VELVET.

VELVET technology is protected under Spanish license laws with international patents pending.

Information and specifications in this document are subject to change without notice.

2025 © Copyright VELVET. All rights reserved

QR Links

[KOSMOS bicolor website link](#)

- [More product details & photos](#)
- [Check the latest version of the user manual.](#)
- [Download the latest firmware update](#)
- [Download the latest DMX map chart](#)

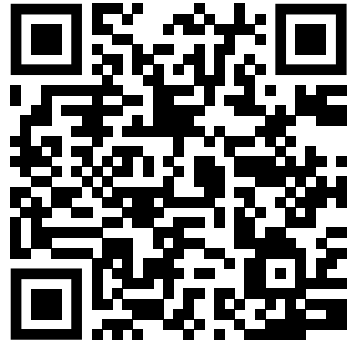





**Design, Engineering
& Production center**

Carrer de la Cerdanya. 11A
08192 — St. Quirze del Vallès
Barcelona (Spain)
+34 937 073 011
info@velvetlight.tv
